

WT-A2332-LS

DC-21GHz Low Pass Filter

Specifications

Serial	Parameters	
1	Cut Off Frequency	21GHz
2	Pass Band Frequency	DC~21GHz
3	Pass Band Insertion Loss	≤1.0dB @ DC~20GHz ≤3.0dB @ 20~21GHz
4	Pass Band VSWR	≤1.6:1
5	Stop Band Attenuation	≥50dB @ 22.2~27GHz
6	Impedance	50 ohms
7	Power	≤15W
8	Connectors	SMA-Female
9	Surface Finish	Guided Oxygen or Black Paint
10	Temperature Range	-55℃ ~ +85℃
11	Net weight	0.0135 KG
12	Configuration	As Below (Size Unit: mm)

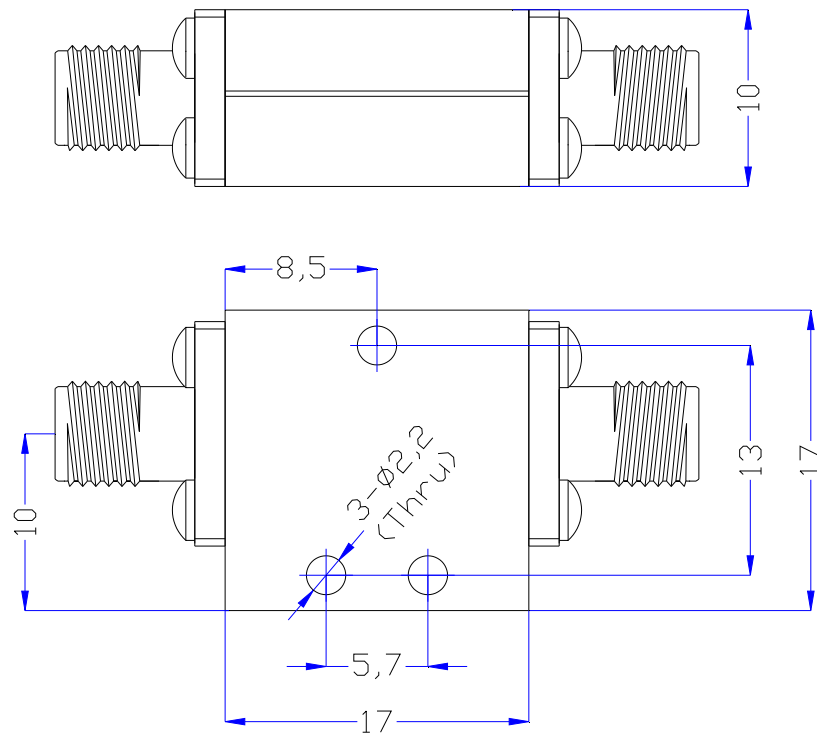

WT Microwave INC.

http://www.wtmicrowave.com E-mail: tech@wtmicrowave.com sales@wtmicrowave.com

http://www.cdweitong.com E-mail: tech@cdweitong.com sales@cdweitong.com

TEL:+86-28-84300332/84300037 FAX:+86-28-84300332-807

Add: Chengdu of China Zip Code:610051